

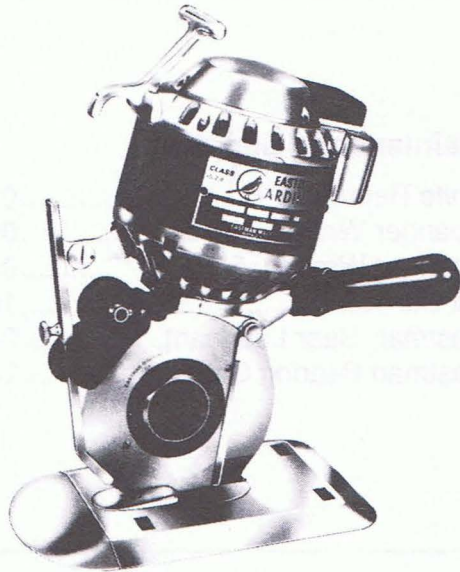

EASTMAN CARDINAL® MAINTENANCE INSTRUCTIONS



The purchaser must instruct all operators on the proper use of the equipment. All standard industrial safety measures and equipment should be provided to protect the operator. Operators must be cautioned that improper use of this equipment can cause bodily injury. If you do not have qualified operators to instruct new persons, contact your Eastman sales representative or write to Eastman Machine factory direct.

CAUTION

Read instructions carefully before starting motor. Be sure that voltage and current are the same as stamped on nameplate. All Eastman machines shown in this catalogue are equipped with sharp blades and extreme caution should be used when this machine is put into use. Use control levers and handles only when operating or handling machine. When machine is not in operation the front knife guard should be kept in the lowered position. When making a cut the knife guard should be raised only enough to clear the material being cut. When this equipment is not being utilized, the power supply should be disconnected from the equipment.

TO OPERATE MACHINE

Turn the switch to the on position; if cutter does not start immediately, return the switch to the off position. Check the line output and be sure that the unit is plugged in properly and is making full contact, then repeat procedure. Do not attempt to start this unit while it is in the material being cut.

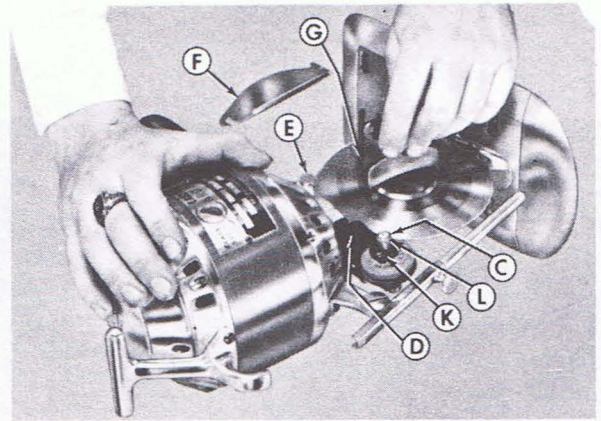

SPANNER WRENCH

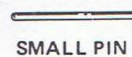

SMALL PIN

WARNING

Before performing any of the following procedures, make sure that the attachment plug has been disconnected from power source.

MAINTENANCE PROCEDURES

- 1 Be sure that the rollers of the base plate are kept lint free.
- 2 Be sure that the terminal pins on the terminal block are kept in good condition to make full contact with the female receptacle.
- 3 Inspect the operating switch periodically to make sure that it is making full contact when in the on position.
- 4 When replacing the knife on this cutting unit, be sure that any lint build-up between the knife and the standard is cleaned out.
- 5 If the cutting unit seems to lag while not cutting, the knife should be removed and the unit should be run without the knife to see if the machine has been over-greased or if there is an obstruction somewhere.

TO REPLACE THE KNIFE

Loosen thumb screw "E" and swing guard "F" to outward position as shown on dotted lines. Turn the knife so the small hole lines up with hole "G" in the standard. Insert the small pin that is with the supplies in hole "G". Remove the lock nut that retains the blade with the special spanner wrench. When installing a new knife, be sure the name Eastman Machine Company is facing outward and that the knife seats on the knife gear. Install knife lock nut and be sure that the throat plate is adjusted as outlined.

CAUTION

Discard used sharp knives with care.

TO ADJUST THROAT PLATE

It is very important that the edge of the knife be as close as possible without touching to the forward position in the slot on the throat plate. The slot in the throat plate "J" should straddle the blade and screws "H" can be loosened and retightened to accomplish this adjustment.



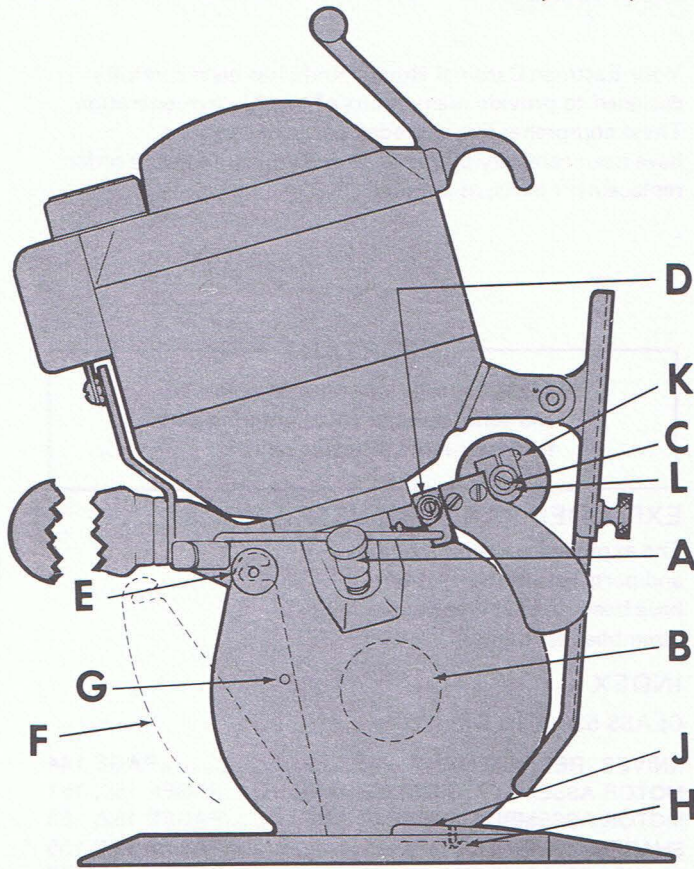

CAUTION

Do not use sewing machine oil or detergent oil. It is entirely too light for cutting machine lubrication. For best results use specially compounded Eastman Oil or at least a good grade of No. 30 motor oil. Do not oil Base Plate Rollers.

REPLACEMENT KNIVES

| Knife Diameter | Carbon Steel | High Speed Steel | High Speed Steel Grooved | High Speed Steel Teflon Coated | Model Used On |
|----------------|--------------|------------------|--------------------------|--------------------------------|---------------|
| 3-1/2 | 80C1-26 | - | - | - | - |
| 4 | 80C1-59 | 80C1-59 HS | 80C1-59 HSG | 80C1-59 HST | 534, 548 |
| 5 | 80C1-101 | 80C1-101 HS | 80C1-101 HSG | 80C1-101 HST | 534, 548 |
| 5-1/4 | 80C1-61 | 80C1-61 HS | 80C1-61 HSG | 80C1-61 HST | 548 |
| 6 | 80C1-39 | 80C1-39 HS | 80C1-39 HSG | 80C1-39 HST | 548, 562 |
| 7-1/2 | 80C1-77/100 | 80C1-77/100 HS | 80C1-77/100 HSG | 80C1-77/100 HST | 562 |

| Knife Diameter | Carbon Slotted | Double-Bevel Hi-Speed |
|----------------|----------------|-----------------------|
| 7-1/2 | 80C1-120 | 80C1-154 |

LUBRICATION

TWICE A DAY

Oil emery wheel spindles at "C".

DO NOT USE AN EXCESS AMOUNT OF OIL.

ONCE A DAY

Lubricate gears, screw grease cup "A" down one-half turn. Refill cup, as required with Eastman Gear Lubricant special formula (242C2).

ONCE A MONTH

Grease knife gear bearing at "B", remove bearing locknut with spanner wrench and a small amount of Eastman Lubriko grease (242C2-2) from tube.

We recommend our Eastman Gear Lubricant special formula (242C2) for gears and Eastman Lubriko grease (242C2-2) for knife gear ball bearing. Do not use Eastman Gear Lubricant for ball bearings or Eastman Lubriko grease for gears.

TO ADJUST EMERY WHEELS

As the Emery Wheels wear away and become farther apart, they must be adjusted. Adjust Emery Wheels from both sides to assure proper centering of the wheels over the knife. Proceed as follows:

- 1 Loosen slotted head screws "K".
- 2 With fingers, turn adjusting bushings "L" until Emery Wheels are as close together as possible without touching and are centered over the knife. Both wheels should grind at the same time when pressed lightly against the knife and there should be no more than 1/32-inch clearance between the two Emery Wheels.
- 3 Tighten slotted head screws "K".

TO REPLACE EMERY WHEELS

- 1 With front of machine facing serviceman, guard rod in down safe position, remove right hand grinding wheel and arm by loosening setscrew "D" and sliding arm off shaft.

- 2 Remove slotted head screw "C" and replace grinding wheel with spindle in right hand arm.
- 3 No need to remove left hand arm from machine. Remove slotted head screw "C" from left hand arm and replace grinding wheel with spindle.
- 4 Re-assemble right hand arm to shaft and adjust wheels to knife as covered above.

Eastman
machine
COMPANY

Eastman
Cutting
Room
Sales

CALL TOLL FREE 1-800-327-2677

From the library of: Superior Sewing Machine & Supply LLC



ILLUSTRATED PARTS LIST



**EASTMAN
CARDINAL®**
**ROUND KNIFE
MACHINES**



ALL PARTS SHOWN ON EXPLODED PARTS ILLUSTRATIONS ARE COMMON TO 548 AND 534 MODELS EXCEPT AS NOTED BY SYMBOLS.

*PARTS REQUIRED FOR MODEL 534 ONLY
†PARTS REQUIRED FOR MODEL 548 ONLY

Your Eastman Cardinal Round Knife has been carefully designed to provide many hours of trouble free operation. These comprehensive exploded parts illustrations have been carefully prepared to enable you to easily order replacement parts, as required.

IMPORTANT

Always specify machine class number and serial number when ordering parts for faster more efficient service.

EXPLODED PARTS ILLUSTRATIONS

The exploded parts illustrations and parts lists in this section have been divided into major assemblies as follows:

INDEX

CLASS 534 AND 548

| | |
|---------------------------------------|----------------|
| KNIVES, REPLACEMENT | PAGE 144 |
| MOTOR ASSEMBLY, SINGLE PHASE | PAGES 150, 151 |
| MOTOR ASSEMBLY, THREE PHASE | PAGES 152, 153 |
| SHARPENER ASSEMBLY | PAGES 154, 155 |
| STANDARD ASSEMBLY | PAGES 156, 157 |
| GUARD ASSEMBLY | PAGES 158, 159 |
| BASE PLATE ASSEMBLY | PAGES 158, 159 |
| BK & CARPET CUTTER | PAGES 160, 161 |
| TERMINAL BLOCK, ATTACHMENT PLUG | PAGE 162 |
| CLASS 562 | PAGE 163 |

FASTENERS REQUIRED TO ASSEMBLE MAJOR COMPONENTS

| Part No. | Description |
|----------|---|
| 20C8-2 | SHARPENER LEVER SCREW |
| 20C13-72 | SCREW, BASE PLATE TO STANDARD (3 Req'd.) |
| 300C12-3 | SCREW, 8-32 x 3/8 RD. HD. (2 Req'd.) |
| 301C14-5 | SCREW, 10-24 x 3/4 FILLISTER HD. (3 Req'd.) |
| 302C12-3 | SCREW, 8-32 x 3/8 FLAT HD. (2 Req'd.) |



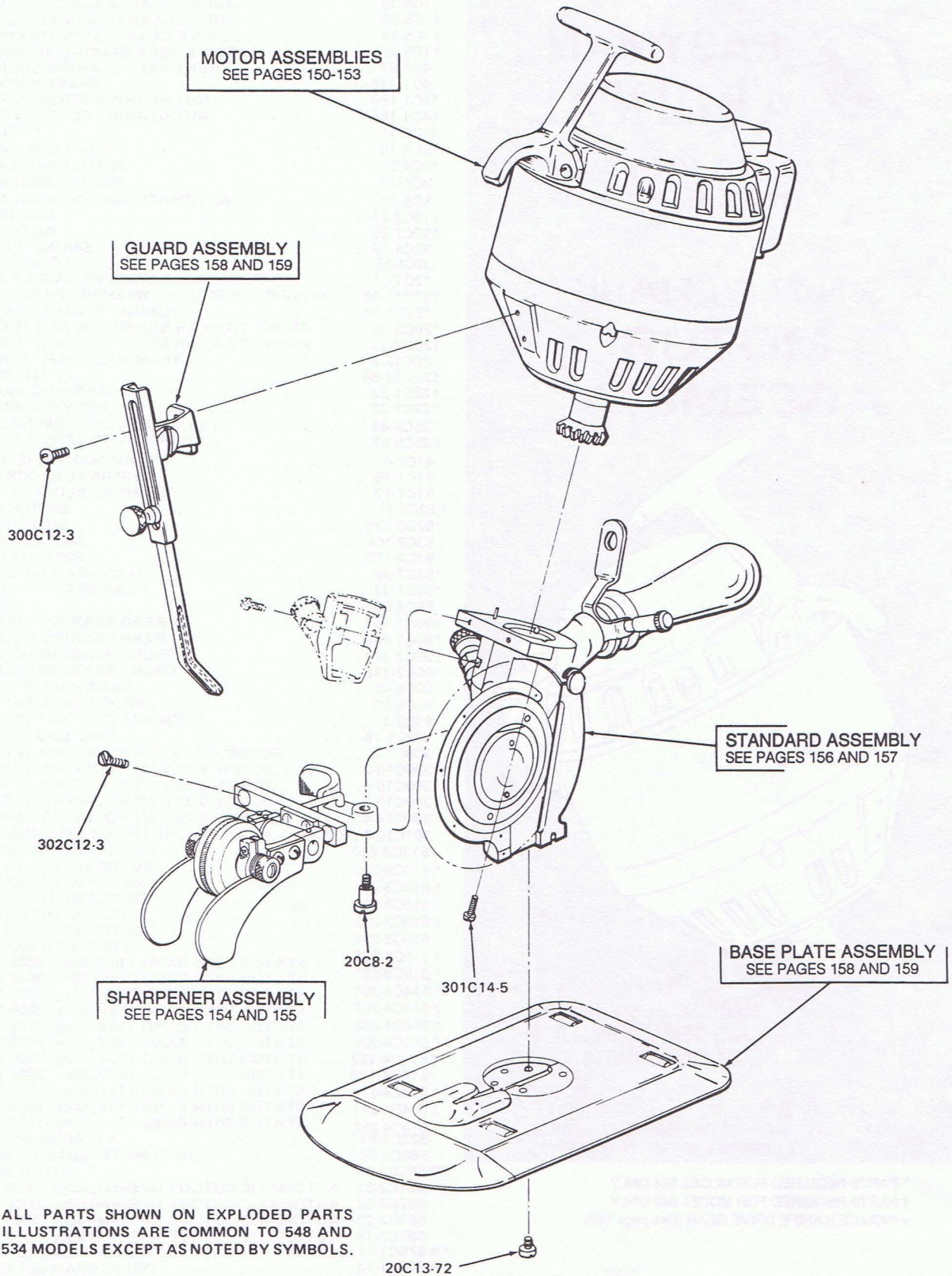

ALL PARTS SHOWN ON EXPLODED PARTS ILLUSTRATIONS ARE COMMON TO 548 AND 534 MODELS EXCEPT AS NOTED BY SYMBOLS.

*PARTS REQUIRED FOR MODEL 534 ONLY
†PARTS REQUIRED FOR MODEL 548 ONLY





EASTMAN CARDINAL®

ROUND KNIFE MACHINES

SINGLE PHASE MOTOR ASSEMBLY

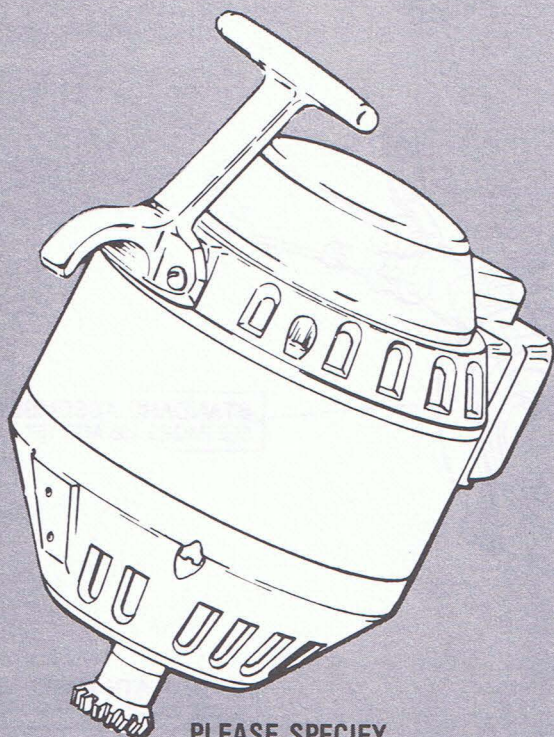

PLEASE SPECIFY
MACHINE CLASS NUMBERS
AND SERIAL NUMBER WHEN
ORDERING PARTS

ALL PARTS SHOWN ON EXPLODED PARTS
ILLUSTRATIONS ARE COMMON TO 548 AND
534 MODELS EXCEPT AS NOTED BY SYMBOLS.

- * PARTS REQUIRED FOR MODEL 534 ONLY
- † PARTS REQUIRED FOR MODEL 548 ONLY
- * INCLUDES KNIFE DRIVE GEAR (See page 157)

| Part No. | Description |
|----------|-------------------------------|
| †1C5-30 | DRIVE GEAR SPACING SLEEVE 52H |
| †1C5-31 | DRIVE GEAR SPACING SLEEVE 6H |

| Part No. | Description |
|------------|--|
| 1C5-32 | DRIVE GEAR SPACING SLEEVE 4H |
| †1C5-33 | DRIVE GEAR SPACING SLEEVE 5H |
| †1C5-34 | DRIVE GEAR SPACING SLEEVE 6L |
| †1C5-36 | DRIVE GEAR SPACING SLEEVE 52L |
| 4C1-87 | FRONT BALL BEARING LOCK NUT |
| 4C1-118 | SHAFT LOCK NUT |
| *4C1-180 | NUT BEARING SCREW (4 Req'd.) |
| †4C1-186 | NUT BEARING SCREW (4 Req'd.) |
| †4C2-91 | LEVER NUT |
| †8C4-14 | SWITCH INSULATION |
| *8C4-20 | SWITCH INSULATION |
| 8C4-72 | SWITCH INSULATION |
| 8C5-10 | AUTOMATIC SWITCH INSULATION |
| †10C2-27 | ROTOR FAN |
| *10C2-30 | ROTOR FAN |
| 12C1-12 | SPRING WASHER |
| 12C1-32 | LOCK WASHER |
| 12C11-17 | DRIVE GEAR SPACING WASHER 4H/5H |
| †12C11-18 | DRIVE GEAR SPACING WASHER 52H/52L/6H/6L |
| 199C1-19 | TONGUE RINGS 4-1PH/7-3PH |
| *20C3-30 | FRONT TO REAR BEARING SCREW (4 Req'd.) |
| †20C3-31 | FRONT TO REAR BEARING SCREW (4 Req'd.) |
| 20C12-2 | TERMINAL SCREW (2 Req'd.) |
| †20C12-64 | LEVER SCREW |
| †22C1-32 | CARRYING HANDLE |
| *22C1-33 | CARRYING HANDLE |
| *25C5-48 | GUARD OVER TERMINAL PINS |
| †25C5-57 | GUARD OVER TERMINAL PINS |
| 47C2-4 | TERMINAL PIN (2 Req'd.) |
| 51C1-16 | TERMINAL BLOCK (Top) |
| 51C1-17 | TERMINAL BLOCK (Bottom) |
| †52C5-171 | SWITCH BASE |
| *52C5-175 | SWITCH BASE |
| †53C2-104 | SWITCH COVER |
| *53C2-107 | SWITCH COVER |
| †53C7-36 | REAR BEARING COVER |
| *53C7-39 | REAR BEARING COVER |
| 55C4-99 | SPACER |
| †90C1-153 | REAR BEARING HOUSING |
| *90C1-158 | REAR BEARING HOUSING |
| †90C2-143 | FRONT BEARING HOUSING |
| *90C2-146 | FRONT BEARING HOUSING |
| 90C6-46 | REAR BALL BEARING |
| 90C6-29 | FRONT BALL BEARING |
| 93C2-1 | TERMINAL CONTACT (2 Req'd.) |
| 199C1-19 | WIRE LUG (4 Req'd.) |
| 300C7-2 | SCREW, 4-36 x 3/16 ROUND HD. (2 Req'd.) |
| 300C10-2 | SCREW, 6-32 x 1/4 ROUND HD. (2 Req'd.) |
| 300C10-4 | SCREW, 6-32 x 3/8 ROUND HD. (2 Req'd.) |
| 300C12-3 | SCREW, 8-32 x 3/8 ROUND HD. (2 Req'd.) |
| 300C14-4 | SCREW, 10-24 x 1/2 ROUND HD. (2 Req'd.) |
| 301C10-3 | SCREW, 6-32x3/8 FILL.HD.(2Req'd 534)(3Req'd 548) |
| †513C3-210 | ROTOR WITH SHAFT 52H |
| †513C3-230 | ROTOR WITH SHAFT 52L |
| †513C3-231 | ROTOR WITH SHAFT 4H |
| †513C3-232 | ROTOR WITH SHAFT 5H |
| †513C3-233 | ROTOR WITH SHAFT 6H |
| †513C3-234 | ROTOR WITH SHAFT 6L |
| †513C3-235 | ROTOR WITH SHAFT 4H |
| *513C3-221 | .STATOR WITH BAND 110V, 60cy, 3600 R.P.M. |
| †514C4-206 | .STATOR WITH BAND 220V, 60cy, 3600 R.P.M. |
| †514C4-207 | .STATOR WITH BAND 220V, 50cy, 3000 R.P.M. |
| †514C4-208 | .STATOR WITH BAND 110V, 50cy, 3000 R.P.M. |
| †514C4-209 | .STATOR WITH BAND 110V, 60cy, 3600 R.P.M. |
| *514C4-122 | .STATOR WITH BAND 220V, 60cy, 3600 R.P.M. |
| *514C4-123 | .STATOR WITH BAND 220V, 50cy, 3000 R.P.M. |
| †514C4-210 | .STATOR WITH BAND 110V, 50cy, 1500 R.P.M. |
| †514C4-211 | .STATOR WITH BAND 110V, 60cy, 1800 R.P.M. |
| †514C4-212 | .STATOR WITH BAND 220V, 50cy, 1500 R.P.M. |
| 523C1-51 | ATTACHMENT PLUG |
| 580C1-70 | AUTOMATIC CUTOUT SWITCH |
| †*580C1-85 | MOTOR SWITCH |
| 597C2-21 | AUTOMATIC CUTOUT (w/Sleeve) 60cy, 3600 R.P.M. |
| 597C2-22 | AUTOMATIC CUTOUT (w/Sleeve) 50cy, 3000 R.P.M. |
| 597C2-23 | AUTOMATIC CUTOUT (w/Sleeve) 60cy, 1800 R.P.M. |
| 597C2-24 | AUTOMATIC CUTOUT (w/Sleeve) 50cy, 1500 R.P.M. |
| †★675C1-11 | DRIVE GEAR SET 4H/5H |
| †★675C1-14 | DRIVE GEAR SET 52H/6H |
| ★675C1-15 | DRIVE GEAR SET 52L/6L |
| 783C1-3 | GROUND WIRE |
| 305C10-1 | SCREW, 6-32 x 1/4 BIND HD. |



Eastman Cardinal Class 534, 548, and 562 Round Knife Machines Parts List

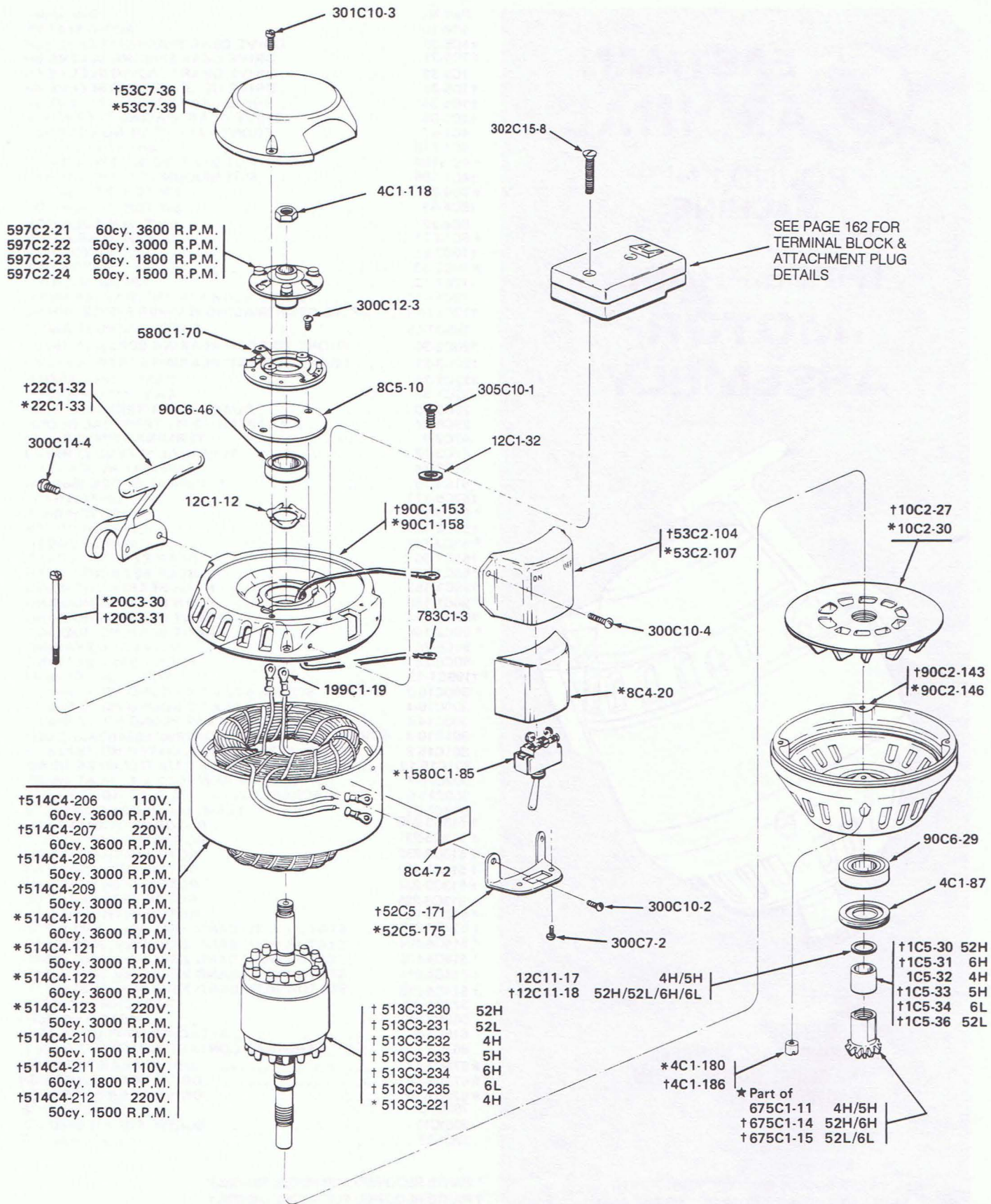

ALL PARTS SHOWN ON EXPLODED PARTS ILLUSTRATIONS ARE COMMON TO 548 AND 534 MODELS EXCEPT AS NOTED BY SYMBOLS.

* PARTS REQUIRED FOR MODEL 534 ONLY
† PARTS REQUIRED FOR MODEL 548 ONLY
* INCLUDES KNIFE DRIVE GEAR (See page 157)



CALL TOLL FREE 1-800-327-2677

From the library of: Superior Sewing Machine & Supply LLC





**ROUND KNIFE
MACHINES**

THREE PHASE MOTOR ASSEMBLY

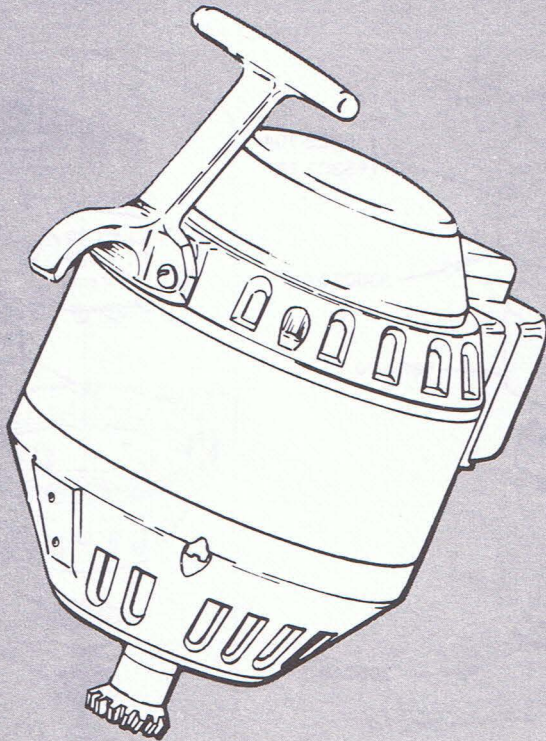

**PLEASE SPECIFY
MACHINE CLASS NUMBERS
AND SERIAL NUMBER WHEN
ORDERING PARTS**

ALL PARTS SHOWN ON EXPLODED PARTS
ILLUSTRATIONS ARE COMMON TO 548 AND
534 MODELS EXCEPT AS NOTED BY SYMBOLS.

| Part No. | Description |
|------------|--|
| 1C4-10 | SPACING SLEEVE |
| †1C5-30 | DRIVE GEAR SPACING SLEEVE 52H |
| †1C5-31 | DRIVE GEAR SPACING SLEEVE 6H |
| 1C5-32 | DRIVE GEAR SPACING SLEEVE 4H |
| †1C5-33 | DRIVE GEAR SPACING SLEEVE 5H |
| †1C5-34 | DRIVE GEAR SPACING SLEEVE 6L |
| †1C5-36 | DRIVE GEAR SPACING SLEEVE 52L |
| 4C1-87 | FRONT BALL BEARING LOCKNUT |
| 4C1-118 | SHAFT LOCK NUT |
| *4C1-180 | NUT BEARING SCREW (4 Req'd.) |
| †4C1-186 | NUT BEARING SCREW (4 Req'd.) |
| *8C4-20 | SWITCH INSULATION |
| †8C4-41 | SWITCH INSULATION |
| 8C4-72 | SWITCH INSULATION |
| *8C13-71 | COVER INSULATION |
| †10C2-27 | ROTOR FAN |
| *10C2-30 | ROTOR FAN |
| 12C1-12 | SPRING WASHER |
| 12C11-17 | DRIVE GEAR SPACING WASHER 4H/5H |
| †12C11-18 | DRIVE GEAR SPACING WASHER 52H/52L/6H/6L |
| 199C1-19 | TONGUE RING (7 Req'd.) |
| *20C3-30 | FRONT TO REAR BEARING SCREW (4 Req'd.) |
| †20C3-31 | FRONT TO REAR BEARING SCREW (4 Req'd.) |
| †22C1-32 | CARRYING HANDLE |
| *22C1-33 | CARRYING HANDLE |
| 25C5-60 | GUARD OVER TERMINAL PINS |
| 29C6-67 | ADAPTER - 3 PH TERMINAL BLOCK |
| 47C2-9 | TERMINAL PIN (3 Req'd.) |
| 47C3-17 | TERMINAL SLEEVE (3 Req'd.) |
| 51C1-18 | TERMINAL BLOCK (Top) |
| 51C1-19 | TERMINAL BLOCK (Bottom) |
| †52C5-171 | SWITCH BASE |
| *52C5-175 | SWITCH BASE |
| †53C2-104 | SWITCH COVER |
| *53C2-107 | SWITCH COVER |
| †53C7-36 | REAR BEARING COVER |
| *53C7-40 | REAR BEARING COVER |
| †90C1-153 | REAR BEARING HOUSING |
| *90C1-156 | REAR BEARING HOUSING |
| †90C2-143 | FRONT BEARING HOUSING |
| *90C2-146 | FRONT BEARING HOUSING |
| 90C6-28 | REAR BALL BEARING |
| 90C6-29 | FRONT BALL BEARING |
| *†199C1-19 | WIRE LUG (4 Req'd.) |
| 300C10-2 | SCREW, 6-32 x 1/4 ROUND HD. (2 Req'd.) |
| 300C10-4 | SCREW, 6-32 x 3/8 ROUND HD. (2 Req'd.) |
| 300C14-4 | SCREW, 10-24 x 1/2 ROUND HD. (2 Req'd.) |
| 301C10-3 | SCREW, 6-32x3/8 FILL.HD.(2Req'd 534)(3Req'd 548) |
| 301C15-8 | SCREW, 10-32 x 1-3/8 FILLISTER HD. (2 Req'd.) |
| 301C15-12 | SCREW 10-32 x 1-1/8 FILLISTER HEAD |
| 302C15-7 | SCREW 10-32 x 1" FLAT HEAD |
| 302C15-9 | SCREW, 10-32 x 1-1/4 FLAT HD. (2 Req'd.) |
| 508C1-22 | TERMINAL BLOCK COMPLETE |
| †513C3-230 | ROTOR WITH SHAFT 52H |
| †513C3-231 | ROTOR WITH SHAFT 52L |
| †513C3-232 | ROTOR WITH SHAFT 4H |
| †513C3-233 | ROTOR WITH SHAFT 5H |
| †513C3-234 | ROTOR WITH SHAFT 6H |
| †513C3-235 | ROTOR WITH SHAFT 6L |
| *513C3-221 | ROTOR WITH SHAFT 4H |
| †514C4-213 | STATOR WITH BAND 220V. 60cy. 3600 R.P.M. |
| *514C4-124 | STATOR WITH BAND 220V. 60cy. 3600 R.P.M. |
| *514C4-125 | STATOR WITH BAND 220V. 50cy. 3000 R.P.M. |
| †514C4-214 | STATOR WITH BAND 220V. 50cy. 3000 R.P.M. |
| †514C4-215 | STATOR WITH BAND 220V. 60cy. 1800 R.P.M. |
| 523C1-38 | ATTACHMENT PLUG |
| 580C1-65 | MOTOR SWITCH |
| 615C1-5 | ATTACHMENT PLUG CLAMP |
| 667C1-1 | TERMINAL CONTACT WITH PIN (3 Req'd.) |
| *675C1-11 | DRIVE GEAR SET 4H/5H |
| †*675C1-14 | DRIVE GEAR SET 52H/6H |
| †*675C1-15 | DRIVE GEAR SET 52L/6L |
| 783C1-3 | GROUND WIRE |
| 3051C10-1 | SCREW, 6-32 x 1/4 BIND HD. |
| 12C1-32 | LOCK WASHER |

* PARTS REQUIRED FOR MODEL 534 ONLY

† PARTS REQUIRED FOR MODEL 548 ONLY

* INCLUDES KNIFE DRIVE GEAR (See page 157)



Eastman Cardinal Class 534, 548, and 562 Round Knife Machines Parts List

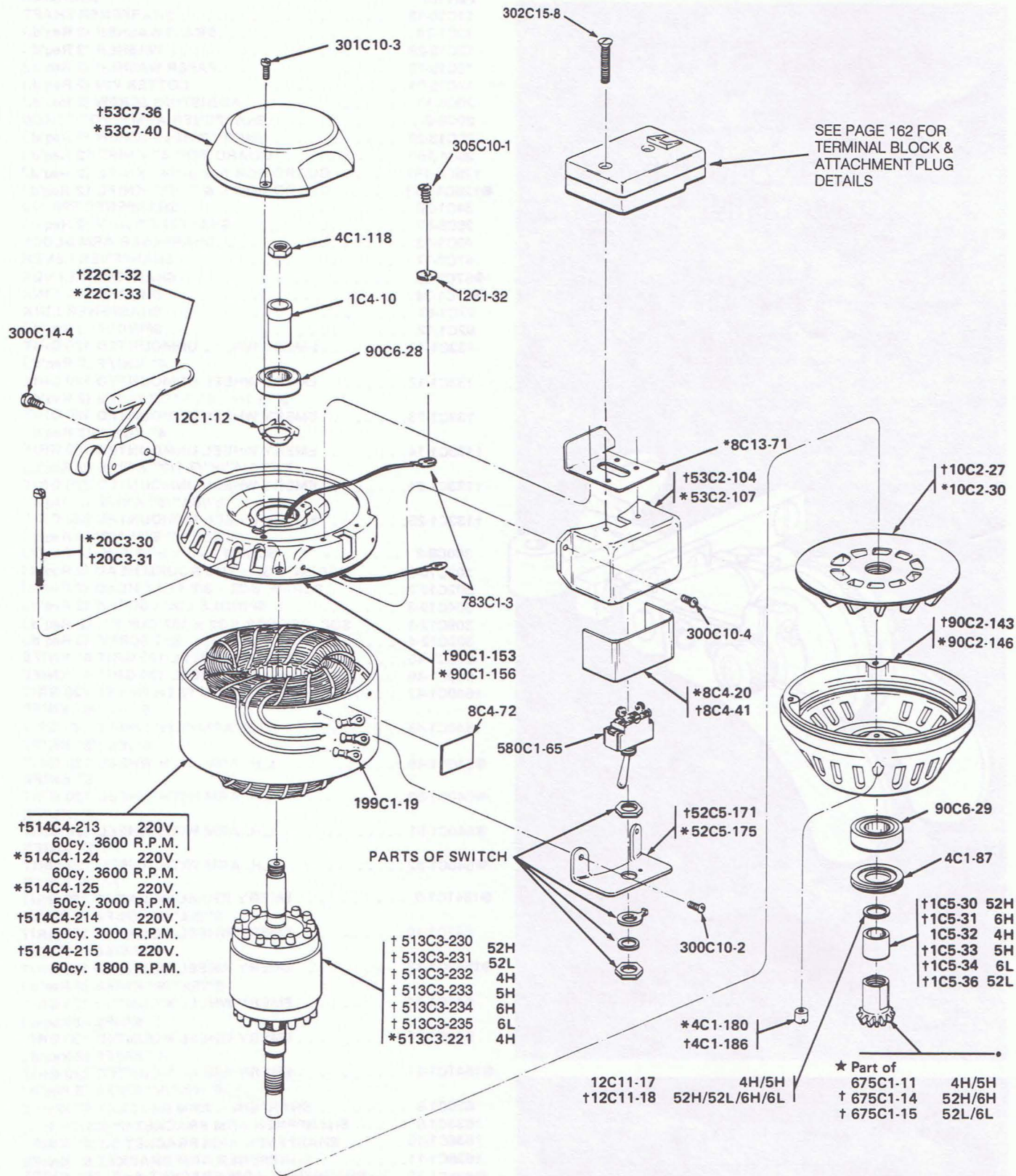

ALL PARTS SHOWN ON EXPLODED PARTS ILLUSTRATIONS ARE COMMON TO 548 AND 534 MODELS EXCEPT AS NOTED BY SYMBOLS.

*PARTS REQUIRED FOR MODEL 534 ONLY
†PARTS REQUIRED FOR MODEL 548 ONLY





**ROUND KNIFE
MACHINES**

SHARPENER ASSEMBLY

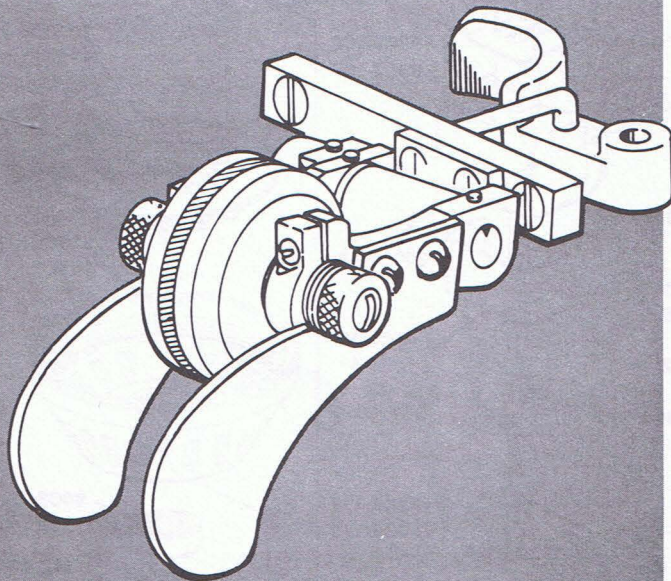

**PLEASE SPECIFY
MACHINE CLASS NUMBERS
AND SERIAL NUMBER WHEN
ORDERING PARTS**

ALL PARTS SHOWN ON EXPLODED PARTS ILLUSTRATIONS ARE COMMON TO 534, 548, AND 562 MODELS EXCEPT AS NOTED BY SYMBOLS

*PARTS REQUIRED FOR MODEL 534 ONLY
†PARTS REQUIRED FOR MODEL 548 ONLY
●PARTS REQUIRED FOR MODEL 562 ONLY

| Part No. | Description |
|------------|--|
| 11C10-18 | SHARPENER SHAFT |
| 12C1-28 | BRASS WASHER (2 Req'd.) |
| 12C15-29 | WASHER (2 Req'd.) |
| 12C15-70 | PAPER WASHER (2 Req'd.) |
| 17C15-71 | COTTER PIN (2 Req'd.) |
| 20C6-11 | ADJUSTING SCREW (2 Req'd.) |
| 20C8-2 | SHARPENER ARM PIVOT SCREW |
| 20C13-20 | EMERY WHEEL SCREW (2 Req'd.) |
| 25C4-160 | GUARD FOR 4" KNIFE (2 Req'd.) |
| †25C4-161 | GUARD FOR 5 & 5-1/4" KNIFE (2 Req'd.) |
| ●†25C4-163 | GUARD FOR 6 & 7-1/2" KNIFE (2 Req'd.) |
| 34C1-20 | SHARPENER SPRING |
| 35C5-57 | SHARPENER ARM (2 Req'd.) |
| 46C3-13 | SHARPENER ARM BLOCK |
| 57C2-17 | SHARPENER LEVER |
| ●57C2-22 | SHARPENER LEVER |
| ●77C1-34 | SHARPENER LINK |
| 77C1-67 | SHARPENER LINK |
| 92C1-12 | SPINDLE (2 Req'd.) |
| 133C1-11 | EMERY WHEEL UNMOUNTED 120 GRIT 4" KNIFE (2 Req'd.) |
| 133C1-12 | EMERY WHEEL UNMOUNTED 120 GRIT 5"/5-1/4"/6"/7-1/2" KNIFE (2 Req'd.) |
| 133C1-13 | EMERY WHEEL UNMOUNTED 150 GRIT 4" KNIFE (2 Req'd.) |
| †133C1-14 | EMERY WHEEL UNMOUNTED 150 GRIT 5"/5-1/4"/6"/7-1/2" KNIFE (2 Req'd.) |
| †133C1-24 | EMERY WHEEL UNMOUNTED 220 GRIT 5"/5 1/4"/6" KNIFE (2 Req'd.) |
| †133C1-25 | EMERY WHEEL UNMOUNTED 220 GRIT 5"/5-1/4"/6"/7-1/2" (2 Req'd.) |
| 300C8-8 | SCREW 4-40 x 5/16 R.H. (4 Req'd.) |
| 300C10-5 | SCREW, 6-32 x 7/16 ROUND HEAD (2 Req'd.) |
| 302C12-3 | SCREW, 8-32 x 3/8 FLAT HEAD (2 Req'd.) |
| 304C10-3 | SPINDLE LOCK SCREW (2 Req'd.) |
| 309C12-1 | SOC. SET SCR 8-32 x 187 CUP PT. (2 Req'd.) |
| 309C12-4 | SET SCREW (3 Req'd.) |
| 540C1-45 | L.H. ARM WITH WHEEL 120 GRIT 4" KNIFE |
| 540C1-46 | R.H. ARM WITH WHEEL 120 GRIT 4" KNIFE |
| †540C1-47 | L.H. ARM WITH WHEEL 120 GRIT 5"/5 1/4"/6" KNIFE |
| †540C1-48 | R.H. ARM WITH WHEEL 120 GRIT 5"/5 1/4"/6" KNIFE |
| ●540C1-49 | L.H. ARM WITH WHEEL 120 GRIT 6" KNIFE |
| ●540C1-50 | R.H. ARM WITH WHEEL 120 GRIT 6" KNIFE |
| ●540C1-51 | L.H. ARM WITH WHEEL 120 GRIT 7-1/2" KNIFE |
| ●540C1-52 | R.H. ARM WITH WHEEL 120 GRIT 7-1/2" KNIFE |
| ●†541C1-9 | EMERY WHEEL MOUNTED 120 GRIT 5"/5 1/4"/6" KNIFE (2 Req'd.) |
| 541C1-10 | EMERY WHEEL MOUNTED 120 GRIT 4" KNIFE (2 Req'd.) |
| ●†541C1-13 | EMERY WHEEL MOUNTED 150 GRIT 5"/5 1/4"/6" KNIFE (2 Req'd.) |
| 541C1-14 | EMERY WHEEL MOUNTED 150 GRIT 4" KNIFE (2 Req'd.) |
| 541C1-20 | EMERY WHEEL MOUNTED 220 GRIT 4" KNIFE (2 Req'd.) |
| ●†541C1-21 | EMERY WHEEL MOUNTED 220 GRIT 5"/5 1/4"/6" KNIFE (2 Req'd.) |
| 636C1-8 | SHARPENER ARM BRACKET 4" KNIFE |
| †636C1-9 | SHARPENER ARM BRACKET 5" KNIFE (BK) |
| †636C1-10 | SHARPENER ARM BRACKET 5-1/4" KNIFE |
| †636C1-11 | SHARPENER ARM BRACKET 6" KNIFE |
| ●636C1-13 | SHARPENER ARM BRACKET 6x & 75x KNIFE |
| 637C1-25 | SHARPENER COMPLETE 4" KNIFE |
| 637C1-26 | SHARPENER COMPLETE 5" KNIFE |
| 637C1-27 | SHARPENER COMPLETE 5-1/4" KNIFE |
| 637C1-28 | SHARPENER COMPLETE 6" KNIFE |
| ●637C1-30 | SHARPENER COMPLETE 6x & 75x KNIFE |



Eastman Cardinal Class 534, 548, and 562 Round Knife Machines Parts List

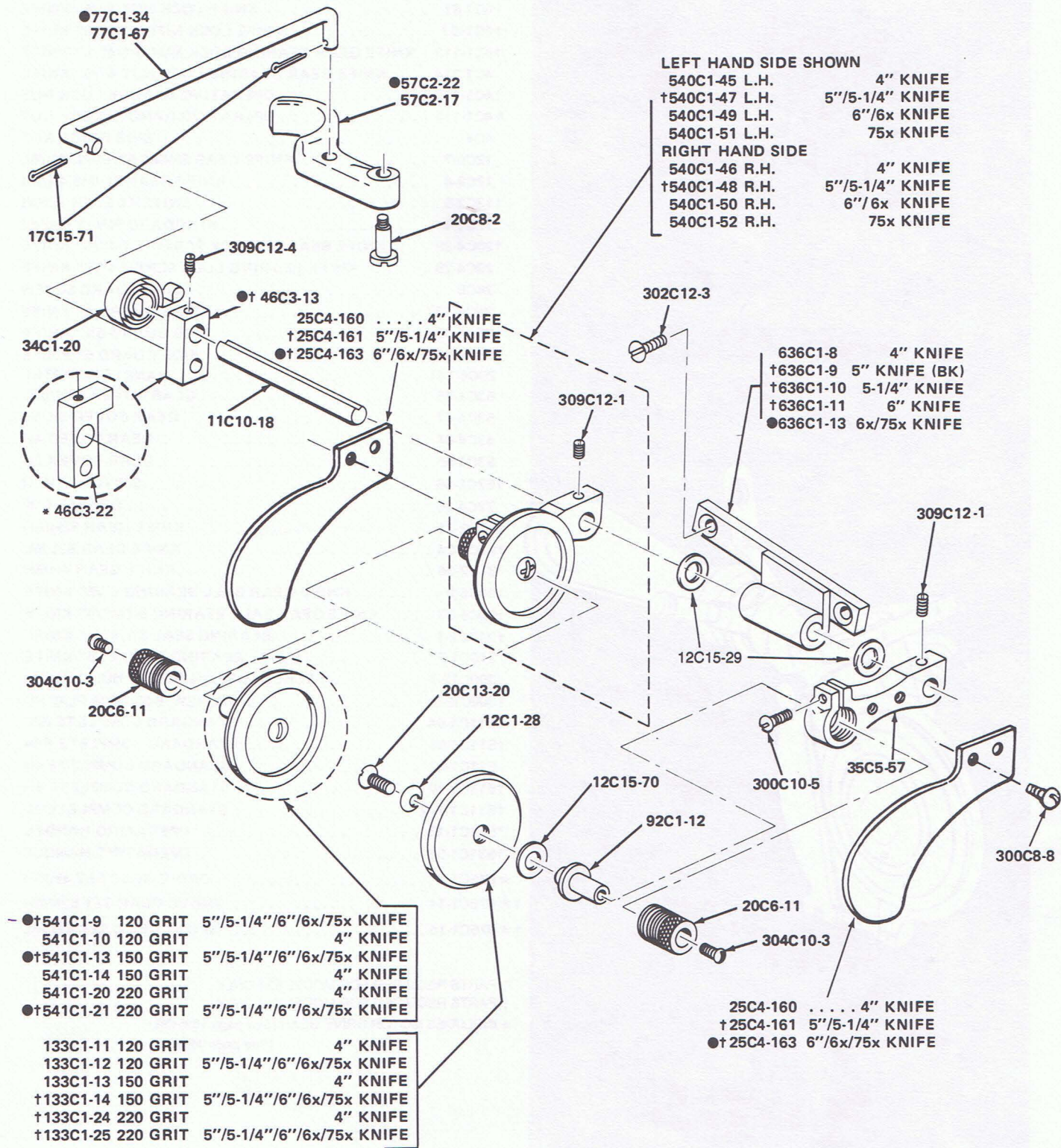

ALL PARTS SHOWN ON EXPLODED PARTS ILLUSTRATIONS ARE COMMON TO 534, 548, AND 562 MODELS EXCEPT AS NOTED BY SYMBOLS

*PARTS REQUIRED FOR MODEL 534 ONLY
 †PARTS REQUIRED FOR MODEL 548 ONLY
 ●PARTS REQUIRED FOR MODEL 562 ONLY



CALL TOLL FREE 1-800-327-2677

From the library of: Superior Sewing Machine & Supply LLC





**EASTMAN
CARDINAL®**
ROUND KNIFE
MACHINES

**STANDARD
ASSEMBLY**

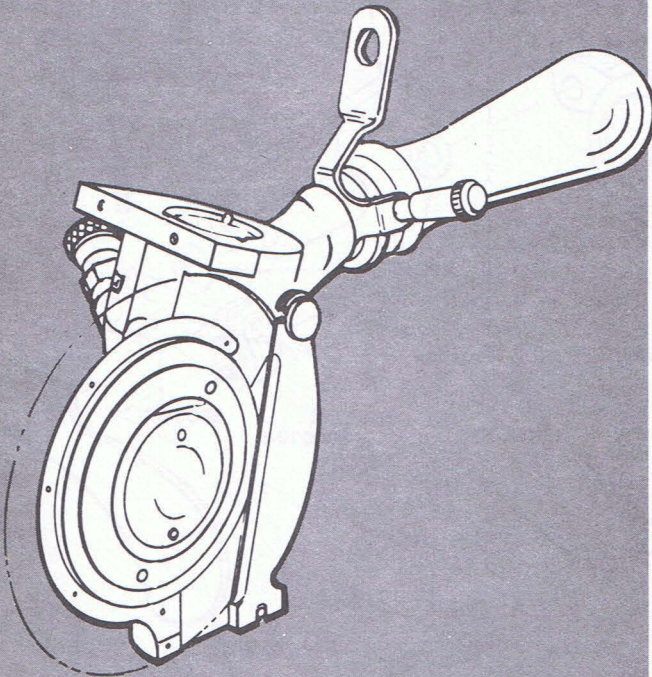

PLEASE SPECIFY
MACHINE CLASS NUMBERS
AND SERIAL NUMBER WHEN
ORDERING PARTS

ALL PARTS SHOWN ON EXPLODED PARTS
ILLUSTRATIONS ARE COMMON TO 548 AND
534 MODELS EXCEPT AS NOTED BY SYMBOLS.

| Part No. | Description |
|-------------|---|
| 4C1-81 | KNIFE LOCK NUT 4"/5" KNIFE |
| †4C1-82 | KNIFE LOCK NUT 5-1/4"/6" KNIFE |
| †4C1-113 | KNIFE GEAR BEARING LOCK NUT 5-1/4"/6" KNIFE |
| 4C1-114 | KNIFE GEAR BEARING LOCK NUT 4"/5" KNIFE |
| †4C1-130 | OPERATING HANDLE LOCK NUT |
| *4C1-115 | OPERATING HANDLE LOCK NUT |
| 4C4 | SIDE GUIDE NUT |
| 12C9-7 | KNIFE GEAR SHIMS 52H/52L/6H/6L |
| 12C9-8 | KNIFE GEAR SHIMS 4H/5H |
| †13C2-5 | SWITCH LEVER KNOB |
| 17C1-4 | STANDARD PIN (2 Req'd.) |
| †20C4-28 | KNIFE BEARING LOCK SCREW 5-1/4"/6" KNIFE |
| 20C4-29 | KNIFE BEARING LOCK SCREW 4"/5" KNIFE |
| 24C6 | SIDE GUARD SCREW |
| 25C4-137 | SIDE GUARD 4" KNIFE |
| †25C4-138 | SIDE GUARD 5 1/2" KNIFE |
| †25C4-140 | SIDE GUARD 6" KNIFE |
| 29C6-141 | HANDLE ADAPTER |
| 53C4-36 | GEAR COVER 52H/52L |
| 53C4-47 | GEAR COVER 6H/6L |
| 53C4-64 | GEAR COVER 4H |
| 53C4-65 | GEAR COVER 5H |
| †57C1-56 | SWITCH LEVER |
| 72C4-20 | GREASE CUP |
| †87C2-21 | KNIFE GEAR 52H/6H |
| †87C2-24 | KNIFE GEAR 52L/6L |
| 87C2-36 | KNIFE GEAR 4H/5H |
| 90C6-9 | KNIFE GEAR BALL BEARING 4"/5" KNIFE |
| †90C6-33 | KNIFE GEAR BALL BEARING 5-1/4"/6" KNIFE |
| †216C1-1 | BEARING SEAL 5-1/4"/6" KNIFE |
| 216C1-2 | BEARING SEAL 4"/5" KNIFE |
| 300C12-7 | SCREW, 8-32 x 5/8 ROUND HD. (2 Req'd.) |
| †302C12-2 | SCREW, 8-32 x 5/16 FLAT HD. |
| †511C1-94 | STANDARD COMPLETE 52L |
| †511C1-96 | STANDARD COMPLETE 52H |
| 511C1-97 | STANDARD COMPLETE 4H |
| †511C1-101 | STANDARD COMPLETE 6H |
| †511C1-102 | STANDARD COMPLETE 6L |
| *531C1-13 | OPERATING HANDLE |
| †531C1-53 | OPERATING HANDLE |
| ★ 675C1-11 | DRIVE GEAR SET 4H/5H |
| †★ 675C1-14 | DRIVE GEAR SET 52H/6H |
| †★ 675C1-15 | DRIVE GEAR SET 52L/6L |

* PARTS REQUIRED FOR MODEL 534 ONLY

† PARTS REQUIRED FOR MODEL 548 ONLY

* INCLUDES MOTOR DRIVE GEAR (See page 152) OR
(See page 153)



Eastman Cardinal Class 534, 548, and 562 Round Knife Machines Parts Lis

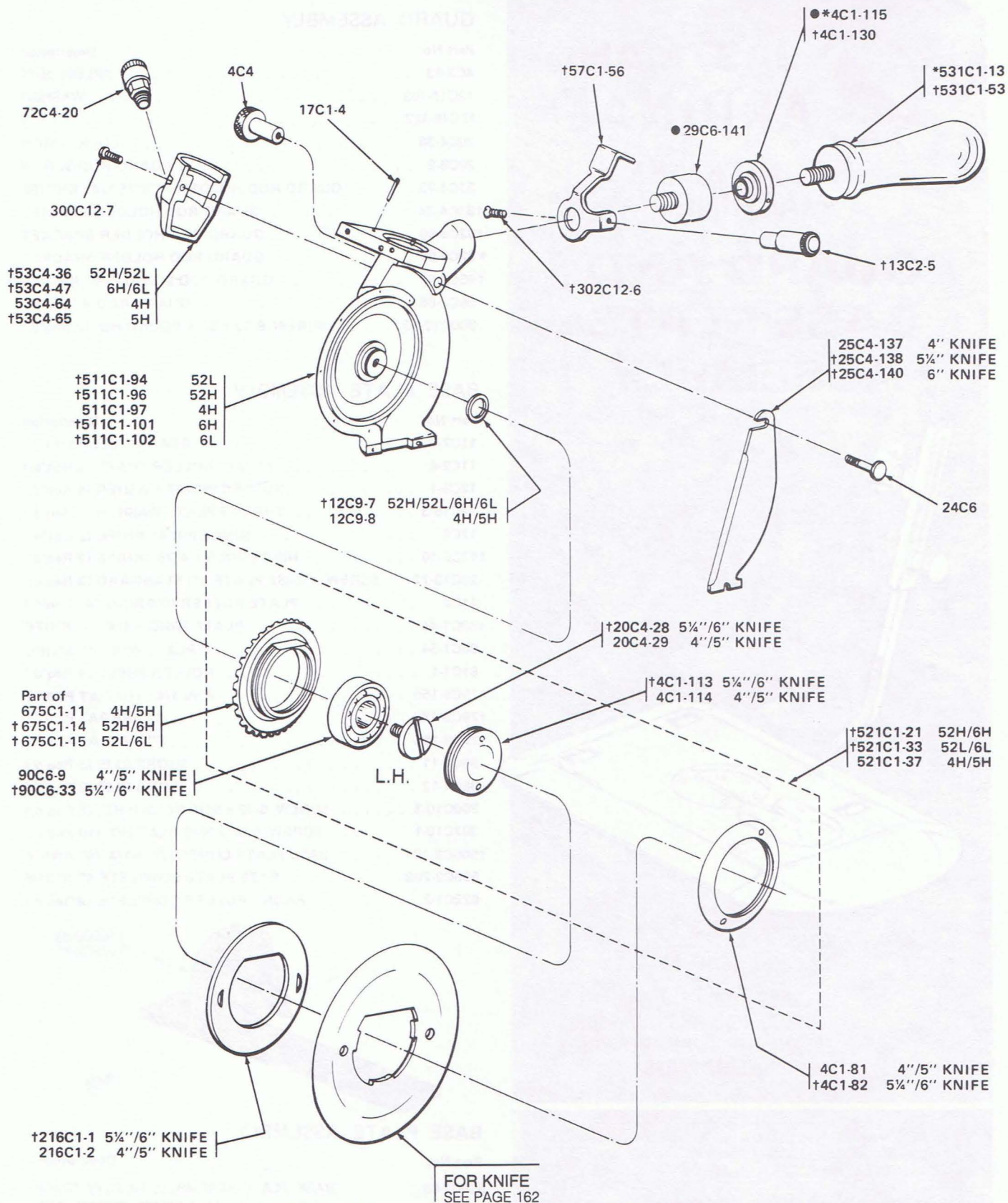

ALL PARTS SHOWN ON EXPLODED PARTS ILLUSTRATIONS ARE COMMON TO 548 AND 534 MODELS EXCEPT AS NOTED BY SYMBOLS.

*PARTS REQUIRED FOR MODEL 534 ONLY
†PARTS REQUIRED FOR MODEL 548 ONLY
●PARTS REQUIRED FOR MODEL 562 ONLY





GUARD AND BASE PLATE ASSEMBLY

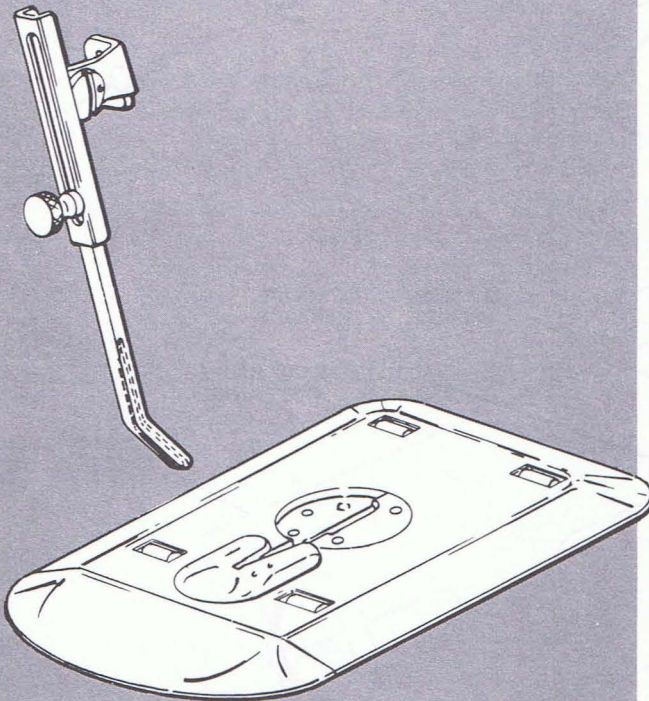

PLEASE SPECIFY
MACHINE CLASS NUMBERS
AND SERIAL NUMBER WHEN
ORDERING PARTS

ALL PARTS SHOWN ON EXPLODED PARTS ILLUSTRATIONS ARE COMMON TO 548 AND 534 MODELS EXCEPT AS NOTED BY SYMBOLS.

*PARTS REQUIRED FOR MODEL 534 ONLY
†PARTS REQUIRED FOR MODEL 548-ONLY

GUARD ASSEMBLY

| Part No. | Description |
|-----------|---|
| 4C2-93 | SPLINE NUT |
| 12C15-103 | WASHER |
| 17C15-123 | PIN |
| 20C4-38 | LOCK SCREW |
| 20C5-2 | GUARD ROD SCREW |
| 33C4-23 | GUARD ROD HOLDER 4"/5"/5-1/4" KNIVES |
| †33C4-24 | GUARD ROD HOLDER 6" KNIFE |
| †62C9-80 | GUARD ROD HOLDER BRACKET |
| *62C9-81 | GUARD ROD HOLDER BRACKET |
| †65C2-67 | GUARD ROD 5"/5-1/4"/6" KNIVES |
| 65C2-66 | GUARD ROD 4" KNIFE |
| 300C12-13 | SCREW, 8-32 x 5/16 ROUND HD. (2 Req'd.) |

BASE PLATE ASSEMBLY

| Part No. | Description |
|------------|---|
| 11C2-3 | REAR ROLLER SHAFT |
| 11C2-4 | FRONT ROLLER SHAFT (2 Req'd.) |
| 12C8-1 | ROLLER SHAFT WASHER (8 Req'd.) |
| 12C15-3 | THROAT PLATE WASHER (2 Req'd.) |
| 17C6 | HINGE PIN 4" KNIFE (2 Req'd.) |
| †17C6-10 | HINGE PIN 5-1/4"/6" KNIFE (2 Req'd.) |
| 20C13-72 | SCREW - BASE PLATE TO STANDARD (3 Req'd.) |
| 41C2 | PLATE ROLLER BEARING (40 Req'd.) |
| †60C1-44 | PLATE WING 5-1/4"/6" KNIFE |
| 60C1-54 | PLATE WING 4" KNIFE |
| 61C1-1 | ROLLER SHELL (4 Req'd.) |
| †79C5-155 | 4"/5-1/4" THROAT PLATE |
| †79C5-184 | 6" THROAT PLATE |
| †79C5-185 | 5" THROAT PLATE |
| 98C4-11 | SHORT CLIP (2 Req'd.) |
| 98C4-12 | LONG CLIP (2 Req'd.) |
| 300C10-3 | SCREW, 6-32 x 5/16 ROUND HD. (2 Req'd.) |
| 302C10-1 | SCREW, 6-32 x 3/16 FLAT HD. (10 Req'd.) |
| †505C3-191 | BASE PLATE COMPLETE 5-1/4"/6" KNIFE |
| 505C3-203 | BASE PLATE COMPLETE 4" KNIFE |
| 622C1-2 | FRONT ROLLER COMPLETE (4 Req'd.) |

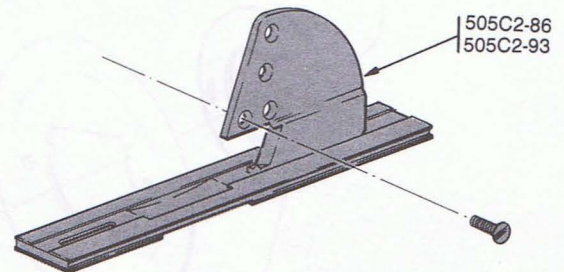

BASE PLATE ASSEMBLY

| Part No. | Description |
|----------|---|
| 505C2-86 | BASE PLATE ASSEMBLY, FALCON TRACK (534 4" BK / 548 4" BK) |
| 505C2-93 | BASE PLATE ASSEMBLY, FALCON TRACK (534 5" BK / 548 5" BK) |



Eastman Cardinal Class 534, 548, and 562 Round Knife Machines Parts List

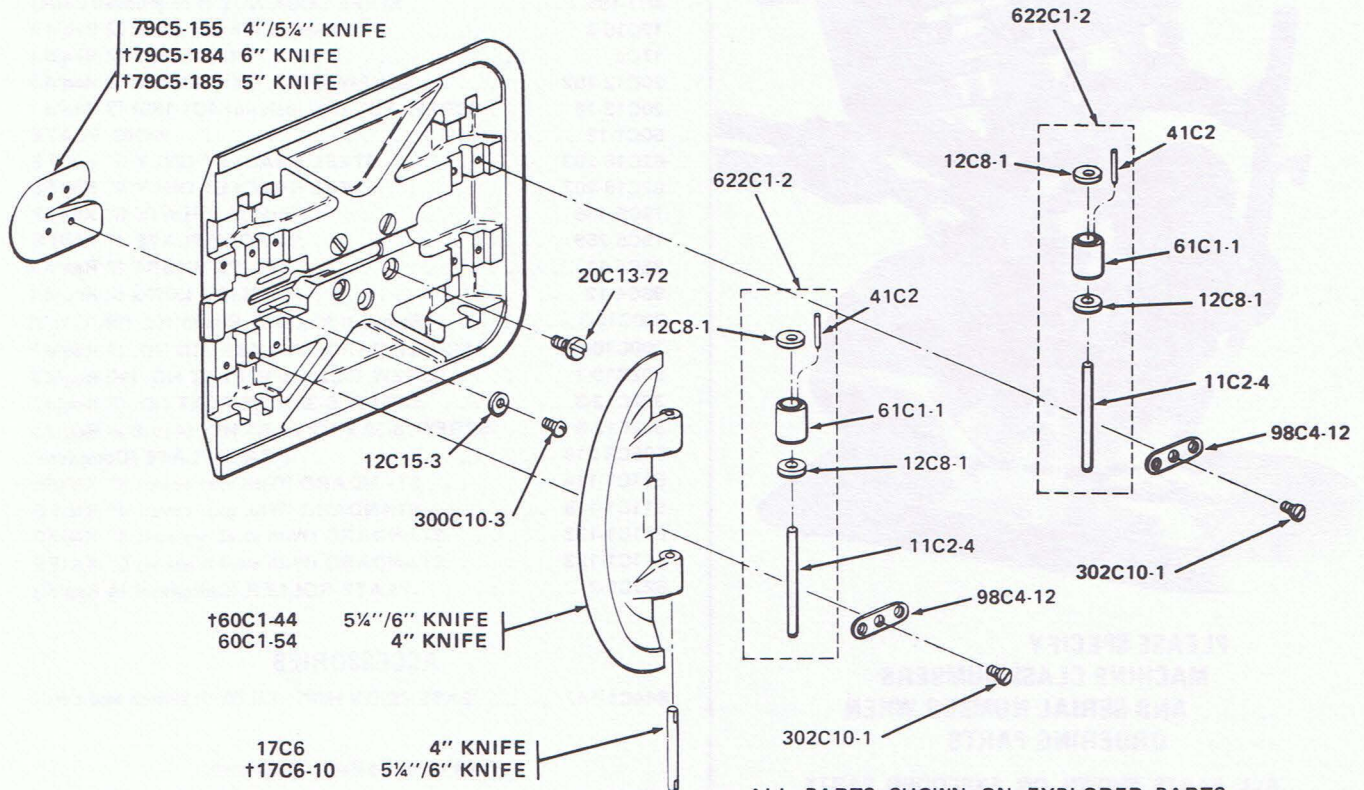
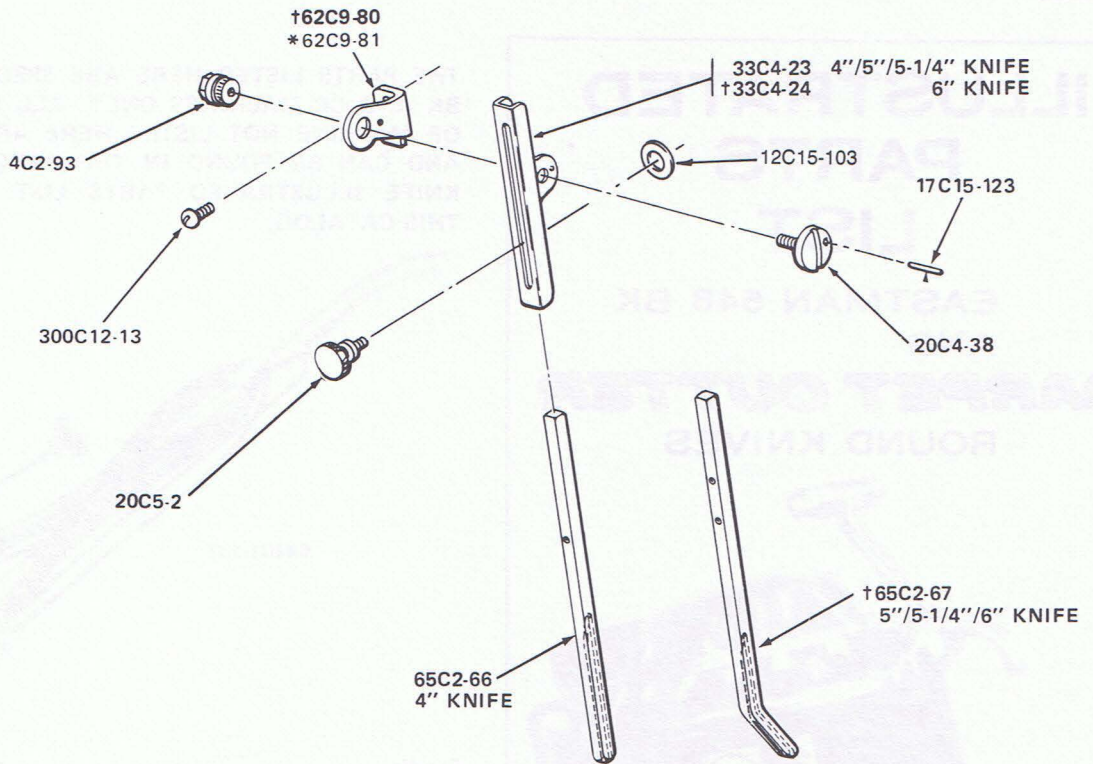

†505C3-191 BASE PLATE COMPLETE 5-1/4''/6'' KNIFE
 *505C3-203 BASE PLATE COMPLETE 4'' KNIFE

ALL PARTS SHOWN ON EXPLODED PARTS ILLUSTRATIONS ARE COMMON TO 548 AND 534 MODELS EXCEPT AS NOTED BY SYMBOLS.

*PARTS REQUIRED FOR MODEL 534 ONLY
 †PARTS REQUIRED FOR MODEL 548 ONLY

